

COMMUNITY GARDEN

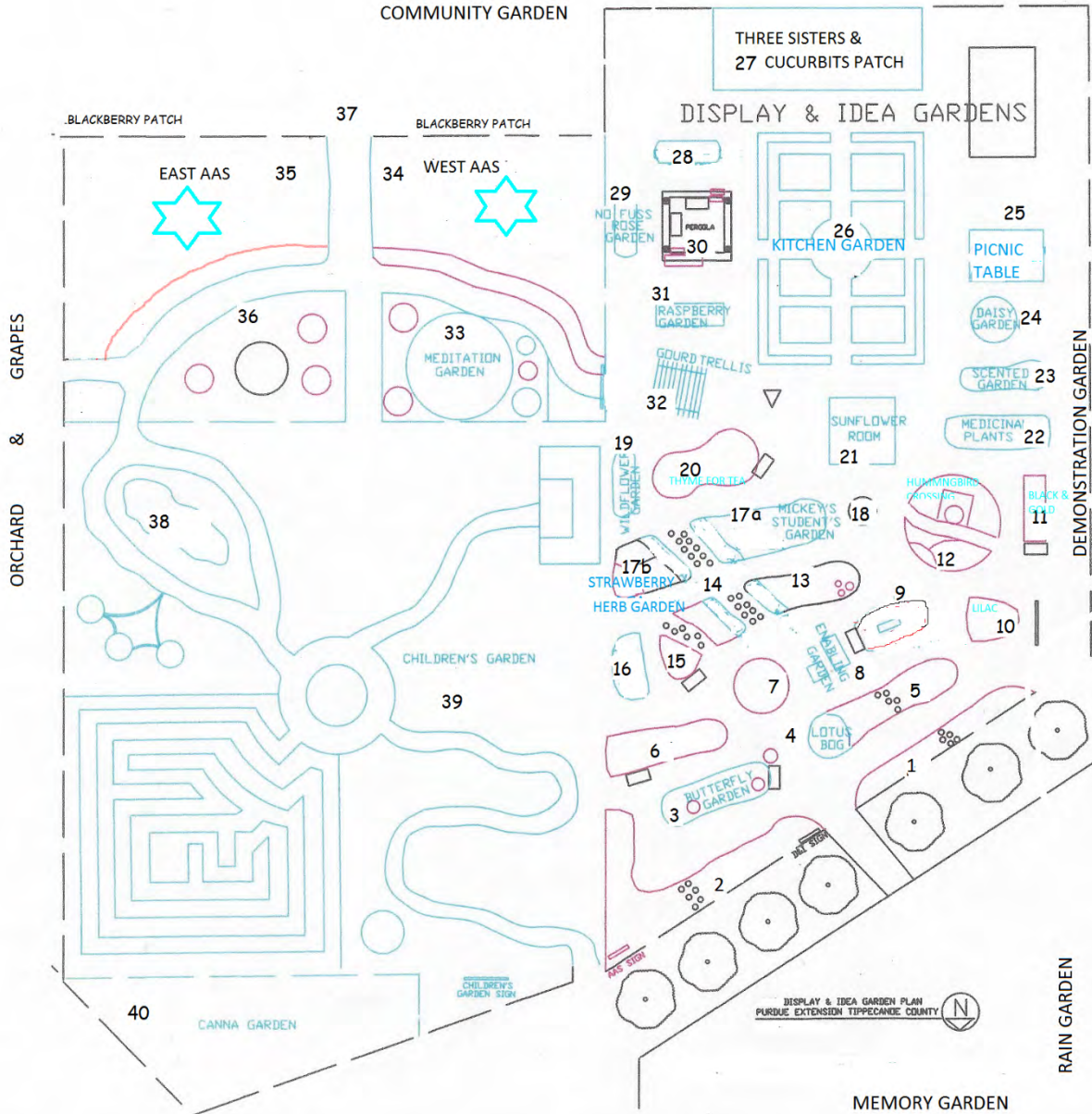

ORCHARD & GRAPES

DEMONSTRATION GARDEN

RAIN GARDEN

MEMORY GARDEN

THREE SISTERS & 27 CUCURBITS PATCH

DISPLAY & IDEA GARDENS

KITCHEN GARDEN

CHILDREN'S GARDEN

DISPLAY & IDEA GARDEN PLAN
PURDUE EXTENSION TIPPECANOE COUNTY



BLACKBERRY PATCH

BLACKBERRY PATCH

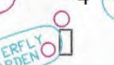
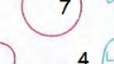
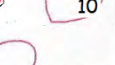
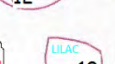
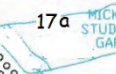
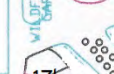
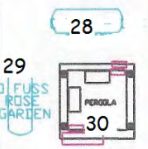
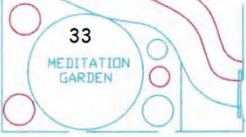
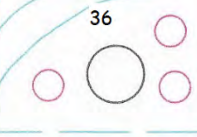
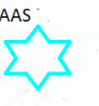

40

CANNA GARDEN

CHILDREN'S GARDEN SIGN

MAY SIGN

DEMONSTRATION GARDEN

1. ENTRANCE RIGHT- A. Brickler E. Carlson
2. ENTRANCE LEFT - A. Nizze, B. Reed
3. BUTTERFLY GARDEN - S. Swick
4. LOTUS BOG - S. Swick
5. PERENNIAL GARDEN - P. Moody, K. Dykhuizen
[HORNBEAN SHRUB]
6. INDIANA INDIGENOUS PLANTS - P. Moody, K. Dykhuizen
7. ENTRANCE CENTER [BIRCH] - S. Swick
8. ENABLING BEDS - C & L. Stafford
9. EASY CARE PRIDE GARDEN - M. Penrod
10. CHINESE LILAC - P. Miller
11. HAIL PURDUE - Long/Redmon/Sadler
12. HUMMING BIRD CROSSING - Long/Redmon/Sadler
13. BED OF HOPE [CANCER AWARENESS] - S. Swick
[ROSE OF SHARON]
14. BASIL LICIOUS - M. Schuerman
15. SECRET GARDEN/TALL NATIVE
[SERVICEBERRY & HYDRANGEA] - J. Straber
16. SUCULENT GARDEN - J. Straber
17. A) MICKEY'S STUDENT GARDEN - M. Penrod
[DOGWOOD]
B) STRAWBERRY BED & HERB - M. Penrod
18. BIRD CENTRAL - S. Swick
19. WILDFLOWER GARDEN- open
20. THYME FOR TEA-Long/Redmond/Sadler [DOGWOOD]
21. SUNFLOWER ROOM - A. Horvath
22. MEDICINAL GARDEN - M. Quinn
23. SCENTED GARDEN - J. Straber
24. DAISY GARDEN – C. Gilles
25. PICNIC – B. Bresahan
26. GARDEN ART - P. Aranas, B. Perez
27. AAS CUCURBITS & THREE SISTERS - M. Penrod
28. TRUMPET ANGEL - P. Aranas
29. NO FUSS ROSE GARDEN - S. Swick
30. SHADE PERGOLA – J. Pickett
31. RED RASPBERRY GARDEN - P. Aranas
32. GOURD TRELIS - T. Cook
33. MEDITATION GARDEN - J. Straber
34. WEST AAS DISPLAY - M. Penrod, S. Swick
35. EAST AAS DISPLAY - M. Penrod, S. Swick
36. PATHWAYS FOR POLLINATORS - M. Penrod
37. PERIMETER FRUIT FENCE - M. Penrod
38. TALL GRASS PRAIRIE & BOG - M. Penrod
39. CHILDREN'S GARDEN - Larson/Cox/Cantrell/Roberts/
Smith/Straber/Keller/Delaney
40. CANNA GARDEN - D. & B. Dilling

ORCHARD and GRAPES - M. Coty, K. & S. Noel, M. Penrod